



Town of Lunenburg

Bluenose Drive Sewer Line Rehabilitation

RFQ No. 221001.00

Addendum No.1

May 18, 2022

The following changes or modifications shall be made to the Tender Documents:

**TO THE SPECIFICATIONS**

**APPENDIX F - CURED-IN-PLACE PIPE - MAINLINE TECHNICAL SPECIFICATION**

**Page 9/10, delete subsection 1.12. and replace with the following:**

- 1.12 WORK RESTRICTIONS .1 Maintain sanitary service for all establishments connected unless approved in writing by affected property owners and agreeable by the Owner. Any work on the weekend must be agreed to in writing by all property owners affected by the work and the Owner. Coordinate any service interruption with the property owner(s) and provide necessary alternative sanitary service arrangements for the duration of the planned disruption. Conducting lining operations outside normal operational hours is permitted. Sewer cleaning and pipe preparation may be performed outside of normal operating hours as long as regular service are maintained. Normal operating hours for each connection are:
- .1 Smoke Pitt BBQ, 10:00am-8:00pm
  - .2 Blue Rocks Timber Framers, 9:00am-4:30pm
  - .3 Ocean Gear Inc, 7:30am-4:00pm



- .4 Ironbound Rigging Co, 8:00am-5:00pm
- .2 Maintain local pedestrian and vehicle traffic. Several businesses within the work area have multiple daily deliveries from large transport trucks, these deliveries need to be maintained during all work activities. Tour busses also travel through this section of road and work must not prevent them for doing so. Maintain access to all driveways or provide alternative site access arrangement with the property owners.
- .3 Limit sound of equipment to levels equal to or less than average ambient street traffic levels. Should residents bring forward concerns regarding noise of work to either the Owner or the Contractor, take measures to respond to these concerns. Should these measures be inadequate, the Owner and Engineer will provide further direction.

## **TO THE DRAWINGS**

### **DRAWING C01 - BLUENOSE DRIVE SITE PLAN**

Delete Drawing C01 – Bluenose Drive Site Plan and replace with new Drawing C01 – Bluenose Drive Site Plan, dated May 18, 2022, attached.

CBCL Limited  
May 18, 2022

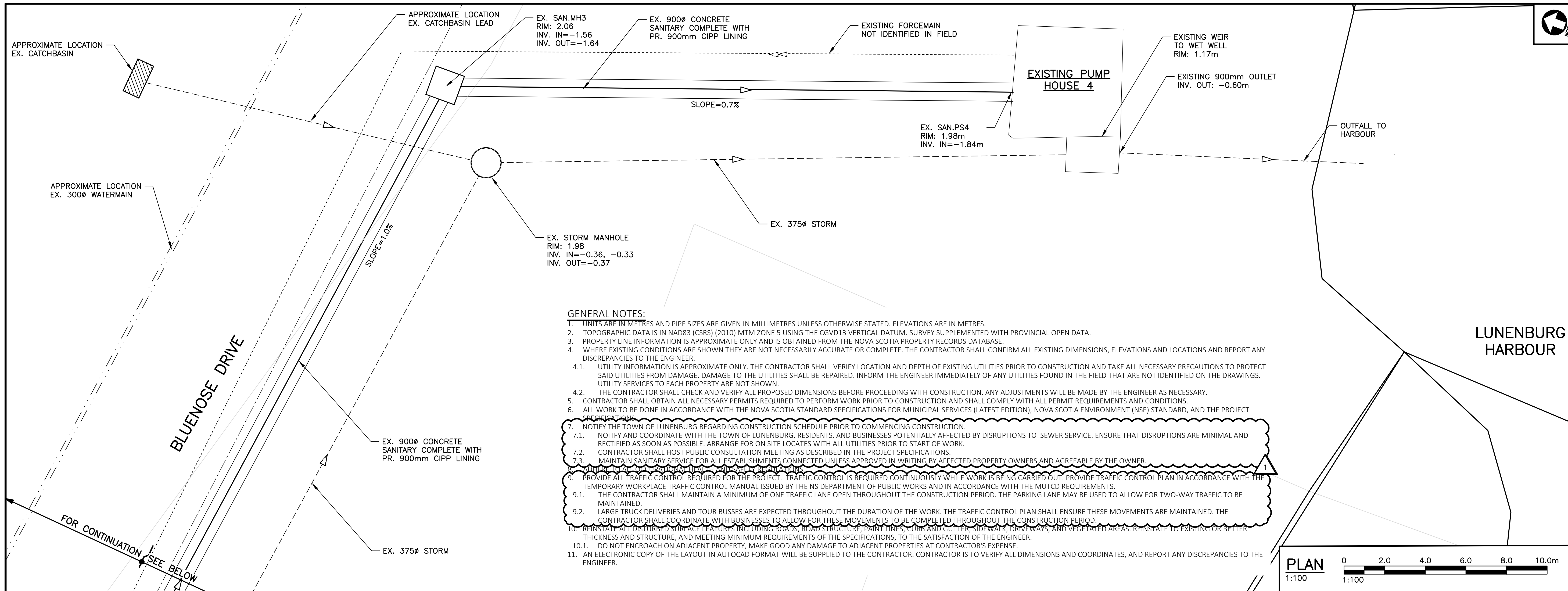

- GENERAL NOTES:**
- UNITS ARE IN METRES AND PIPE SIZES ARE GIVEN IN MILLIMETRES UNLESS OTHERWISE STATED. ELEVATIONS ARE IN METRES.
  - TOPOGRAPHIC DATA IS IN NAD83 (CSRS) (2010) MTM ZONE 5 USING THE CGVD13 VERTICAL DATUM. SURVEY SUPPLEMENTED WITH PROVINCIAL OPEN DATA.
  - PROPERTY LINE INFORMATION IS APPROXIMATE ONLY AND IS OBTAINED FROM THE NOVA SCOTIA PROPERTY RECORDS DATABASE.
  - WHERE EXISTING CONDITIONS ARE SHOWN THEY ARE NOT NECESSARILY ACCURATE OR COMPLETE. THE CONTRACTOR SHALL CONFIRM ALL EXISTING DIMENSIONS, ELEVATIONS AND LOCATIONS AND REPORT ANY DISCREPANCIES TO THE ENGINEER.
  - UTILITY INFORMATION IS APPROXIMATE ONLY. THE CONTRACTOR SHALL VERIFY LOCATION AND DEPTH OF EXISTING UTILITIES PRIOR TO CONSTRUCTION AND TAKE ALL NECESSARY PRECAUTIONS TO PROTECT SAID UTILITIES FROM DAMAGE. DAMAGE TO THE UTILITIES SHALL BE REPAIRED. INFORM THE ENGINEER IMMEDIATELY OF ANY UTILITIES FOUND IN THE FIELD THAT ARE NOT IDENTIFIED ON THE DRAWINGS. UTILITY SERVICES TO EACH PROPERTY ARE NOT SHOWN.
  - THE CONTRACTOR SHALL CHECK AND VERIFY ALL PROPOSED DIMENSIONS BEFORE PROCEEDING WITH CONSTRUCTION. ANY ADJUSTMENTS WILL BE MADE BY THE ENGINEER AS NECESSARY.
  - CONTRACTOR SHALL OBTAIN ALL NECESSARY PERMITS REQUIRED TO PERFORM WORK PRIOR TO CONSTRUCTION AND SHALL COMPLY WITH ALL PERMIT REQUIREMENTS AND CONDITIONS.
  - ALL WORK TO BE DONE IN ACCORDANCE WITH THE NOVA SCOTIA STANDARD SPECIFICATIONS FOR MUNICIPAL SERVICES (LATEST EDITION), NOVA SCOTIA ENVIRONMENT (NSE) STANDARD, AND THE PROJECT SPECIFIC GUIDE.
  - NOTIFY THE TOWN OF LUNENBURG REGARDING CONSTRUCTION SCHEDULE PRIOR TO COMMENCING CONSTRUCTION.
    - NOTIFY AND COORDINATE WITH THE TOWN OF LUNENBURG, RESIDENTS, AND BUSINESSES POTENTIALLY AFFECTED BY DISRUPTIONS TO SEWER SERVICE. ENSURE THAT DISRUPTIONS ARE MINIMAL AND RECTIFIED AS SOON AS POSSIBLE. ARRANGE FOR ON SITE LOCATES WITH ALL UTILITIES PRIOR TO START OF WORK.
    - CONTRACTOR SHALL HOST PUBLIC CONSULTATION MEETING AS DESCRIBED IN THE PROJECT SPECIFICATIONS.
    - MAINTAIN SANITARY SERVICE FOR ALL ESTABLISHMENTS CONNECTED UNLESS APPROVED IN WRITING BY AFFECTED PROPERTY OWNERS AND AGREEABLE BY THE OWNER.
  - PROVIDE ALL TRAFFIC CONTROL REQUIRED FOR THE PROJECT. TRAFFIC CONTROL IS REQUIRED CONTINUOUSLY WHILE WORK IS BEING CARRIED OUT. PROVIDE TRAFFIC CONTROL PLAN IN ACCORDANCE WITH THE TEMPORARY WORKPLACE TRAFFIC CONTROL MANUAL ISSUED BY THE NS DEPARTMENT OF PUBLIC WORKS AND IN ACCORDANCE WITH THE MUTCD REQUIREMENTS.
    - THE CONTRACTOR SHALL MAINTAIN A MINIMUM OF ONE TRAFFIC LANE OPEN THROUGHOUT THE CONSTRUCTION PERIOD. THE PARKING LANE MAY BE USED TO ALLOW FOR TWO-WAY TRAFFIC TO BE MAINTAINED.
    - LARGE TRUCK DELIVERIES AND TOUR BUSES ARE EXPECTED THROUGHOUT THE DURATION OF THE WORK. THE TRAFFIC CONTROL PLAN SHALL ENSURE THESE MOVEMENTS ARE MAINTAINED. THE CONTRACTOR SHALL COORDINATE WITH BUSINESSES TO ALLOW FOR THESE MOVEMENTS TO BE COMPLETED THROUGHOUT THE CONSTRUCTION PERIOD.
  - REINSTALL DISTURBED SURFACE FINISHES INCLUDING ROADS, ROAD STRUCTURE, PAINT LINES, CURBS AND GUTTERS, SIDEWALK, DRIVEWAYS, AND VEGETATED AREAS. REINSTATE TO EXISTING OR BETTER THICKNESS AND STRUCTURE, AND MEETING MINIMUM REQUIREMENTS OF THE SPECIFICATIONS, TO THE SATISFACTION OF THE ENGINEER.
    - DO NOT ENCROACH ON ADJACENT PROPERTY, MAKE GOOD ANY DAMAGE TO ADJACENT PROPERTIES AT CONTRACTOR'S EXPENSE.
  - AN ELECTRONIC COPY OF THE LAYOUT IN AUTOCAD FORMAT WILL BE SUPPLIED TO THE CONTRACTOR. CONTRACTOR IS TO VERIFY ALL DIMENSIONS AND COORDINATES, AND REPORT ANY DISCREPANCIES TO THE ENGINEER.

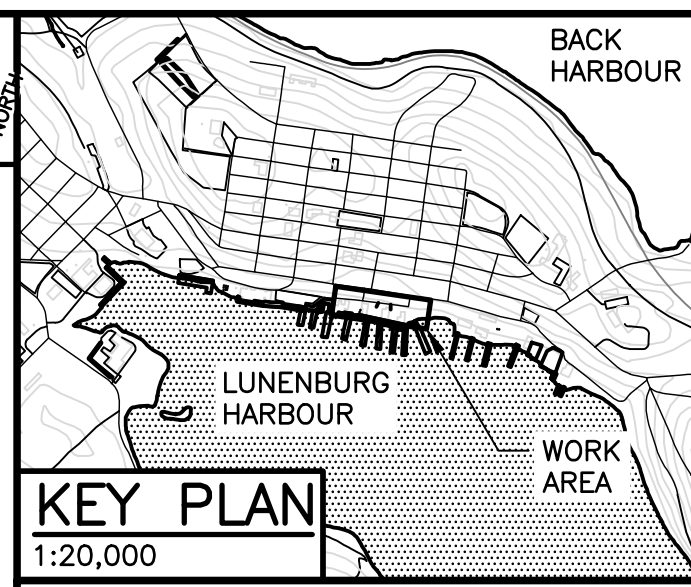

- LEGEND**
- PROPERTY LINE
  - CIPP LINING SECTION
  - EXISTING SANITARY SEWER
  - EXISTING SANITARY LATERAL
  - EXISTING STORM SEWER
  - EXISTING WATER MAIN
  - EXISTING SANITARY FORCE
  - EXISTING STORM MANHOLE
  - EXISTING FIRE HYDRANT
  - EXISTING CATCH BASIN
  - EXISTING SANITARY MANHOLE

- SEDIMENT CONTROL NOTES**
- ALL WORK SHALL BE IN ACCORDANCE WITH THE LATEST REVISION OF NOVA SCOTIA ENVIRONMENT'S EROSION AND SEDIMENT CONTROL HANDBOOK FOR CONSTRUCTION SITES.
  - CONTRACTOR IS RESPONSIBLE FOR ALL ENVIRONMENTAL EROSION AND SILTATION CONTROL. CONTRACTOR TO DESIGN PROVIDE AND IMPLEMENT SILTATION CONTROL MEASURES AS ESTABLISHED BY NSE AND THE EROSION AND SEDIMENTATION CONTROL HANDBOOK FOR CONSTRUCTION SITES. EROSION AND SILTATION DEVICES TO BE IN PLACE BEFORE COMMENCING WORK.
  - INSTALL SEDIMENT FILTER BAGS AS REQUIRED BY SITE CONDITIONS TO PREVENT SEDIMENT FROM ENTERING STORM SYSTEM.
  - IT SHALL BE THE RESPONSIBILITY OF THE CONTRACTOR TO OBTAIN NECESSARY ENVIRONMENTAL PERMITS FROM APPLICABLE AUTHORITIES PRIOR TO CONSTRUCTION.

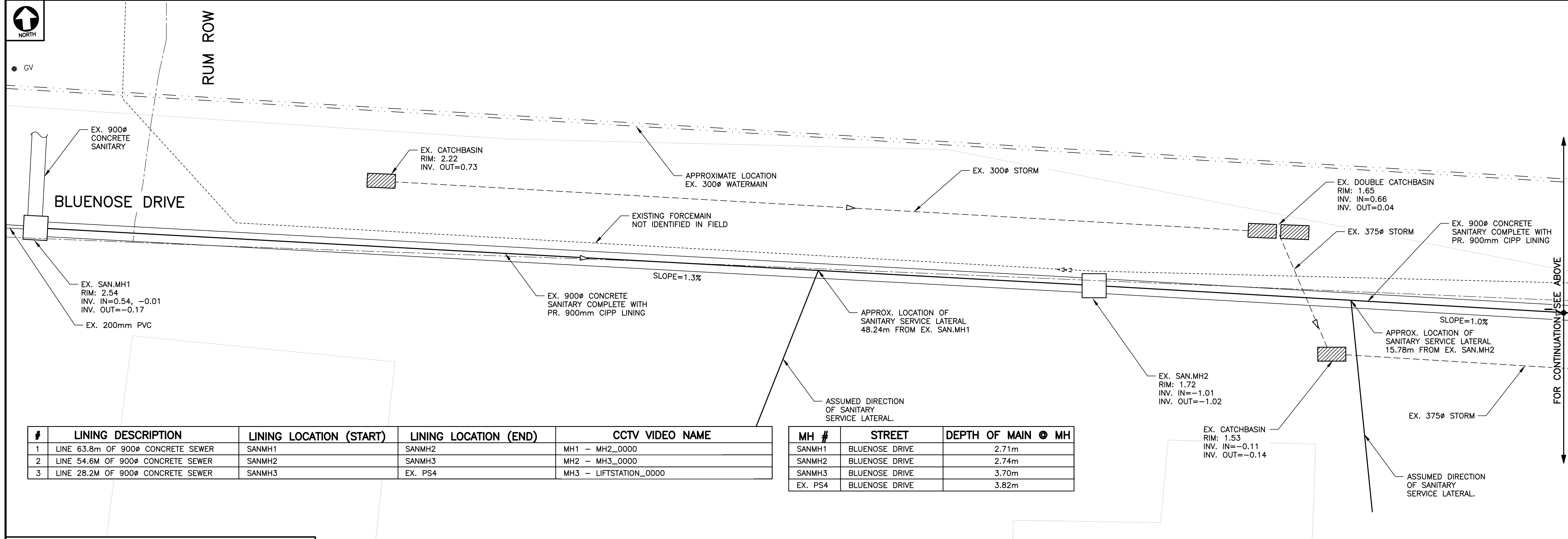

#	LINING DESCRIPTION	LINING LOCATION (START)	LINING LOCATION (END)	CCTV VIDEO NAME
1	LINE 63.8m OF 900# CONCRETE SEWER	SANMH1	SANMH2	MH1 - MH2_0000
2	LINE 54.6m OF 900# CONCRETE SEWER	SANMH2	SANMH3	MH2 - MH3_0000
3	LINE 28.2m OF 900# CONCRETE SEWER	SANMH3	EX. PS4	MH3 - LIFTSTATION_0000

MH #	STREET	DEPTH OF MAIN @ MH
SANMH1	BLUENOSE DRIVE	2.71m
SANMH2	BLUENOSE DRIVE	2.74m
SANMH3	BLUENOSE DRIVE	3.70m
EX. PS4	BLUENOSE DRIVE	3.82m

No.	Description	Date	By
0	ISSUED FOR RFP	MAY 06/22	AB
1	ISSUED FOR ADDENDUM No.1	MAY 18/22	AB

Revision or Issue

u t V \ 7 Q y V - V " y k 8

o Q u t " u - k @ u k y o @ V a u y ) ' "

CIVIL

" Q y - V \ o - ) k @ - o @ - h o V

**CBCL**

CBCL No	Contract No	Date 'y8'	Scale 'oV\ u-)
		Designed	Drawn
		Checked	Approved
		Sheet No	Drawing No
			<b>C01</b>